

RC1

Monroe® RideRefine™ RC1 add-on valve utilizes frequency dependent damping to smooth out high-frequency wheel motions. This add-on valve is highly tunable, enabling vehicle manufacturers to select the ideal comfort profile for short piston strokes in each vehicle model.

At high frequencies, main-valve bypass directs oil into RC1 valve, providing separate, tunable damping of wheel frequencies for more balanced, refined and agile ride.

At low frequencies, the damper's main valve resumes normal operation.

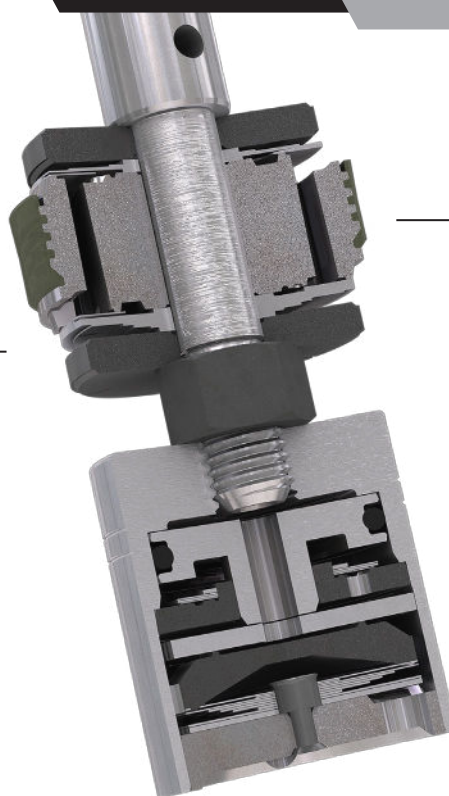

Examples of vehicles equipped with RC1:

Jaguar XF
Jeep Compass
Jeep Wrangler
AMG G 500
Ford Fiesta ST
Volvo Polestar

1. Main-valve bypass directs oil into RC1 valve, providing separate, tunable damping of wheel frequencies for more balanced, refined and agile ride.
2. At the end of the piston stroke, damper's main valve resumes normal operation.